



P-3 GSE Order Search Back Next

stc11000 Part Number

- STC11000-3
 - LOGISTIC INFORMATION
 - DIMENSIONS
 - ALTERNATE PART NUMBERS
 - USAGE INFORMATION
 - CONNECT TO IPB
 - F0048 - ENGINE QUICK CHANGE

- STC-1100-3
- STC1204
- STC1205
- SU5C0010
- SU5C-0010
- SU5-C-0010
- SW-1
- SW130
- SW130-301
- SWE 54
- SWE 63
- SWE 67
- SWE 8100
- SWE 8271
- SWE 84060
- SWE 843196
- SWE 84347
- SWE 84349
- SWE 845402
- SWE 846380
- SWE 846390
- SWE 86072
- SWE 866390
- SWE67
- SWE8100
- SWE8200
- SWE8271
- SWE84036
- SWE843196
- SWE843196-1
- SWE84347
- SWE84347E
- SWE84349

F0048 - ENGINE QUICK CHANGE UNIT SLING

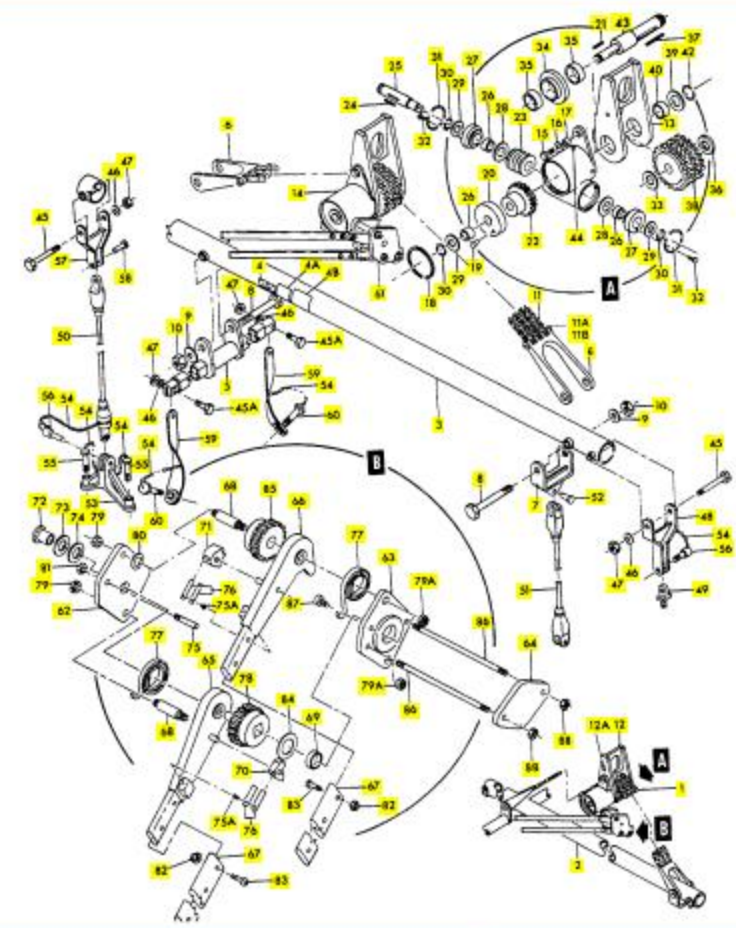

	Index No.	Part Number	FSCM	1234567	Description	Description cont'd.	Units per Assy	Usable On Code	SM& R CODE
	1	STC11000-3			SLING ASSY, POWERPLANT, QEC, ... VARIABLE CENTER-OF-GRAVITY /07132/ /BKDN, NAVAIR 01-75PAA-2-52, WP 010-00/		1		PEOHD
	2	STC1217-3		*	SLING ASSY, POWERPLANT, QEC, VARIABLE CENTER-OF-GRAVITY / 07132/		1		ADHHD
	3	STC11001		**	SPREADER ASSY, /WELDED/ /07132/		1.		MO
	4	STC90394-3		**	PLATE, INSTRUCTION /07132/		1		
	4A	STC90697-1		**	PLATE, TEST RECORD /07132/		1.		
	4B	STC90706-1		**	PLATE, IDENTIFICATION		1.		